

HOBART

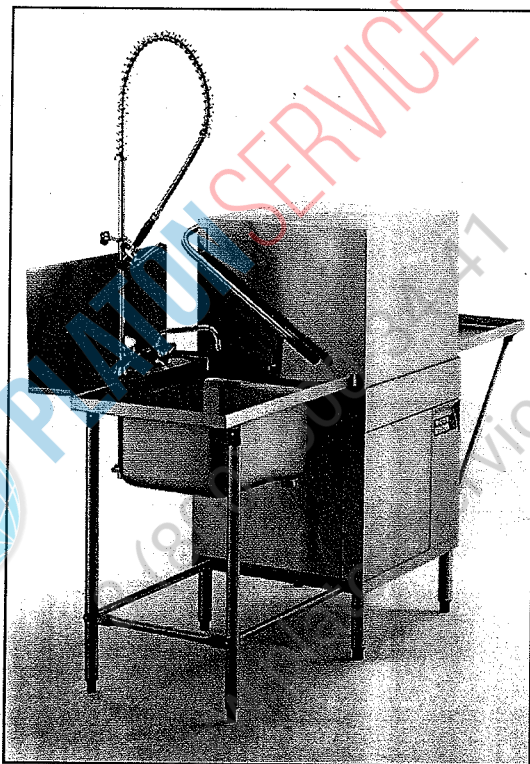

HX

Spare Parts
Pièces Détachées
Ersatzteile
Onderdelen

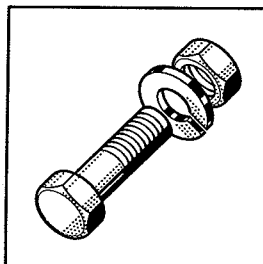

Contents

Frame and Panels	4
Tank and support	5
Filters and tankheating	6
Booster	7
Wash pump	9
Rinse pump	10
Wash and rinse system	11
Fill, anti-siphon-device and drain	12
Softener	13
Fill and regeneration pipework	14
Dispensers	15
Front base	16
Control panel	17
Electrical parts	19

Inhalt

Gestell und Verkleidungen	4
Tank und Untergestell	5
Siebe und Tankheizung	6
Erhitzer	7
Waschpumpe	9
Klarspülpumpe	10
Wasch- und Klarspülsystem	11
Füllung, Rücksaugverhinderer und Ablauf	12
Enthärter	13
Füll- und Regenerierleitung	14
Dosiergeräte	15
Untere Frontverkleidung	16
Schalterblende	17
Elektroteile	19

Sommaire

Châssis et Panneaux	4
Bac et socle	5
Filtres et chauffage du bac	6
Chaudière	7
Pompe de lavage	9
Pompe de rinçage	10
Système de lavage et de rinçage	11
Remplissage, brise-vide et vidange	12
Adoucisseur	13
Tuyauterie de remplissage	14
Doseurs	15
Panneau frontal inférieur	16
Panneau de commande	17
Pièces électriques	19

Inhoud

Frame en Panelen	4
Tank en uitbreiding	5
Zeven en tankverwarming	6
Booster	7
Waspomp	9
Spoelpomp	10
Was- en spoelsysteem	11
Water toevoer, vacuumbreaker en afvoer	12
Ontharding	13
Vul- en regenerieerleiding	14
Doseerapparaten	15
Onder front panel	16
Schakelpanel en elektrische delen	17
Elektrische delen	19

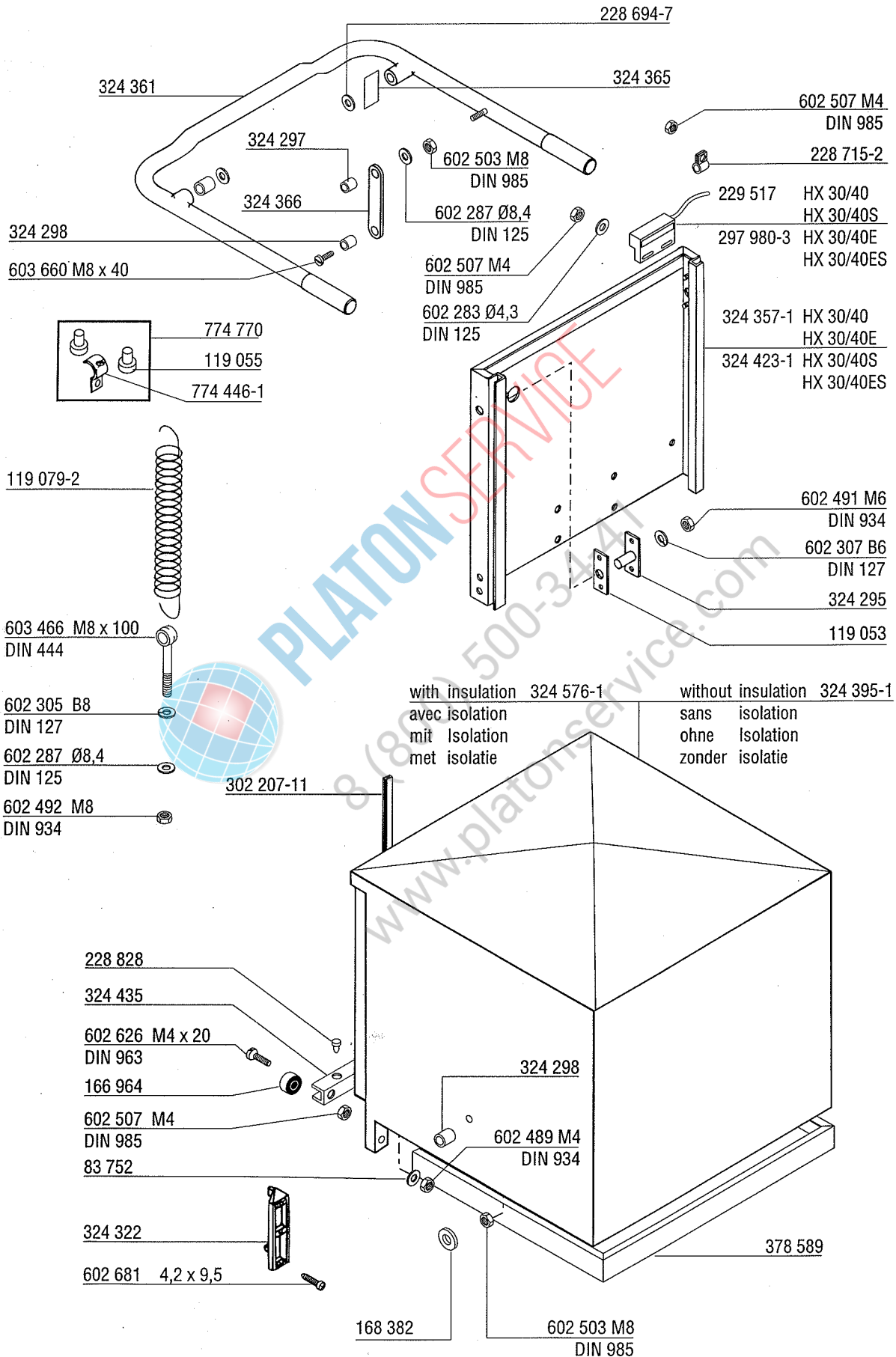

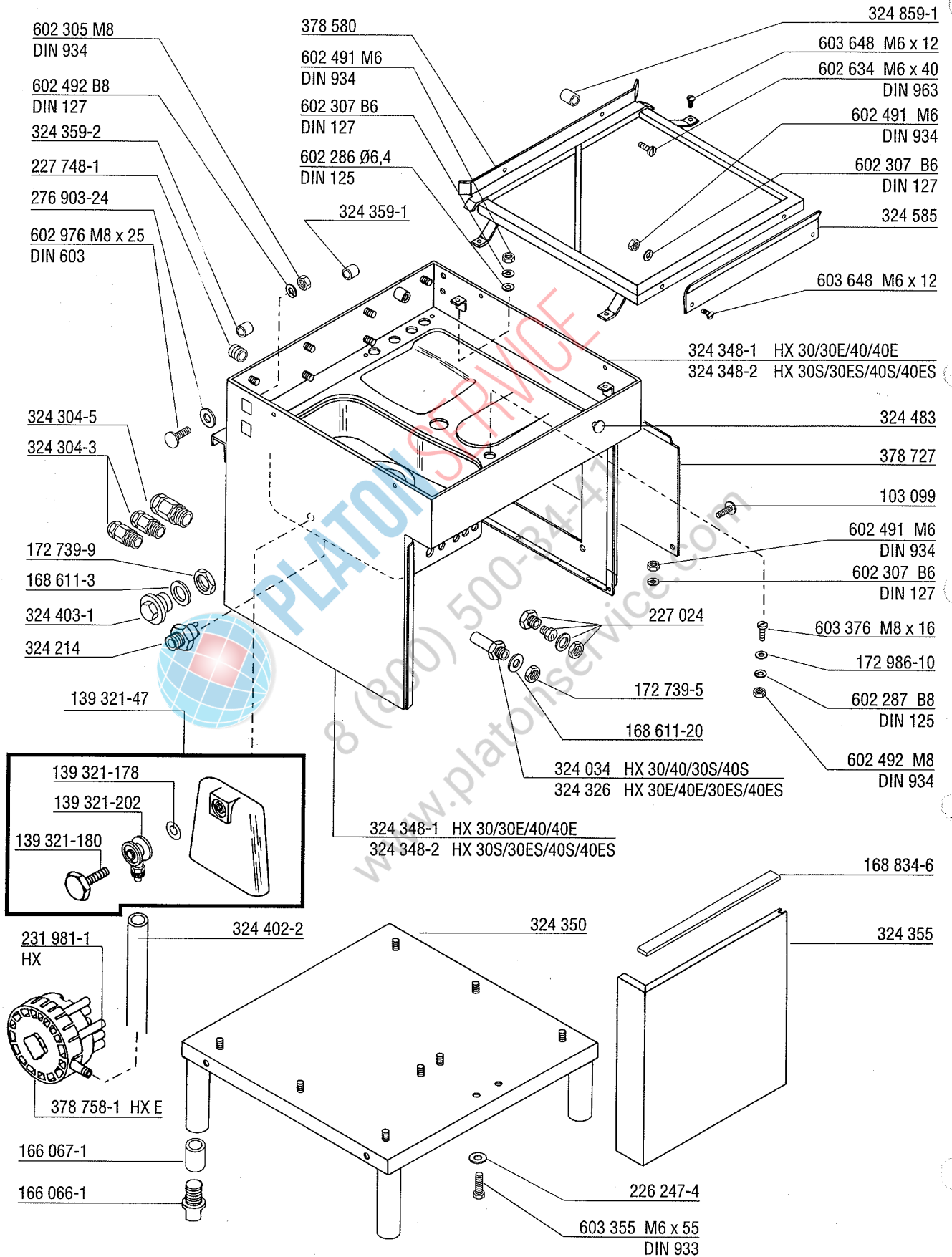

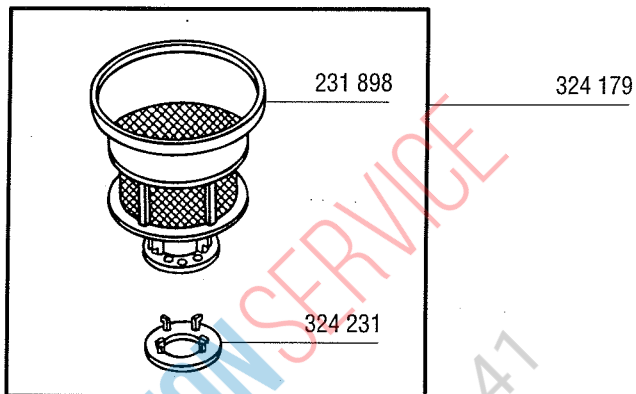
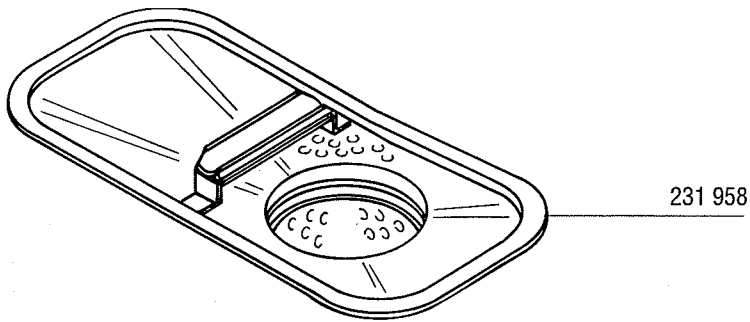

231 982-10 440 V 610 W
 231 982-9 254 V 610 W

602 646 M3 x 10
 DIN 84

602 294 B3
 DIN 127

602 489 M4
 DIN 934

602 308 B4
 DIN 127

602 646 M3 x 10
 DIN 84

602 294 B3
 DIN 127

602 488 M3
 DIN 934

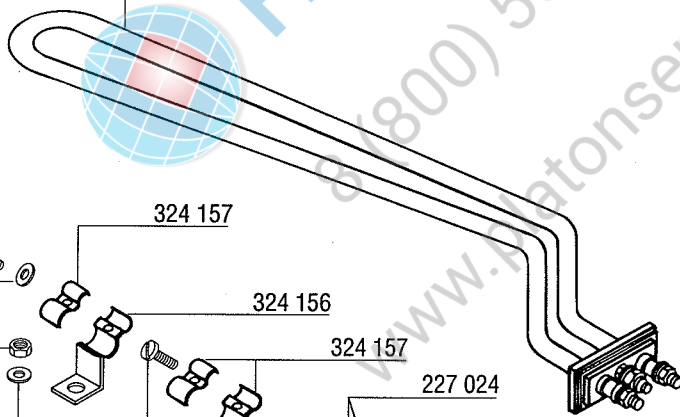

226 505 HX
 227 879 HX E

602 308 B4
 DIN 127

602 687 M4 x 6
 DIN 7985

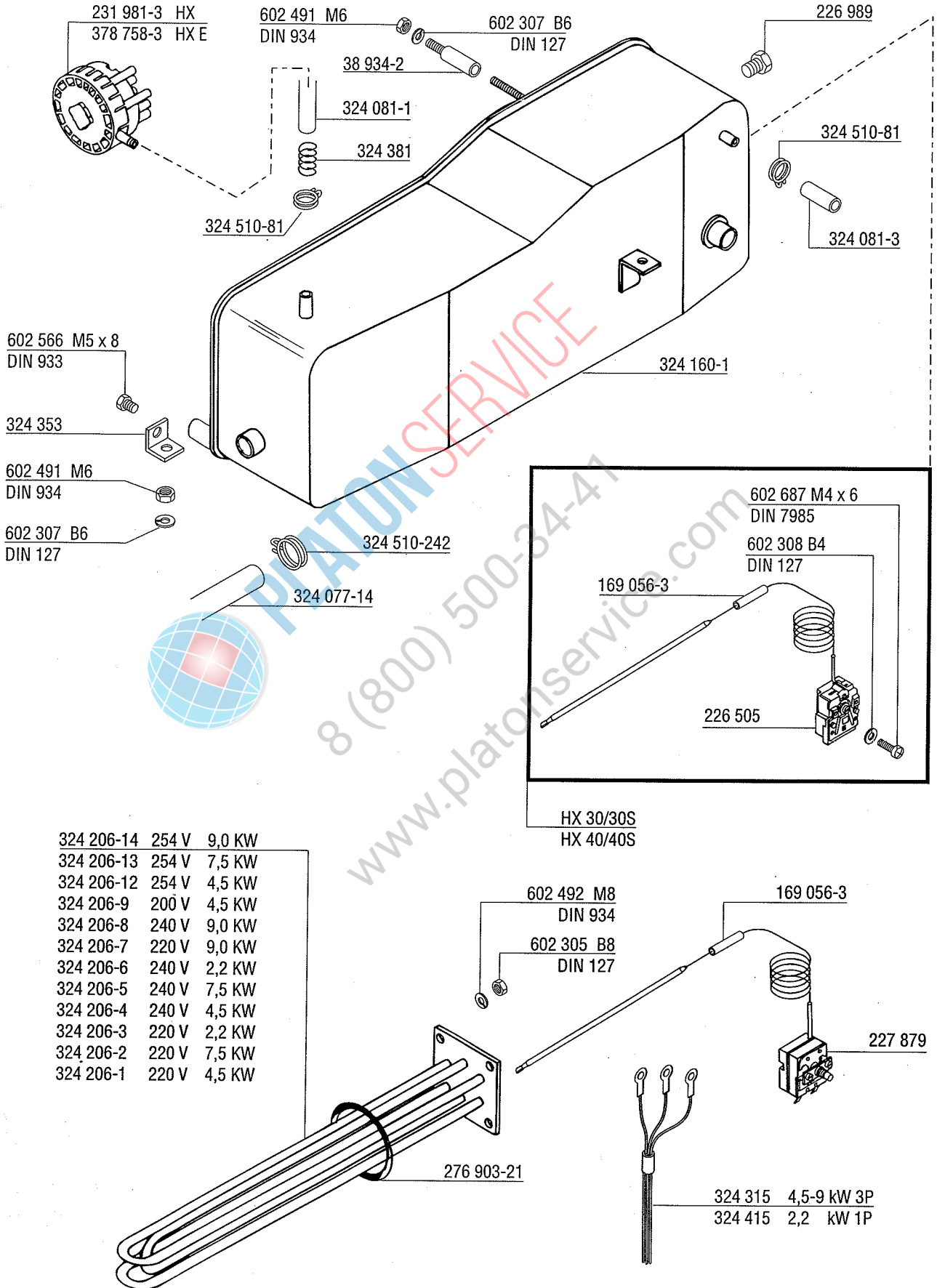

324 206-14	254 V	9,0 KW
324 206-13	254 V	7,5 KW
324 206-12	254 V	4,5 KW
324 206-9	200 V	4,5 KW
324 206-8	240 V	9,0 KW
324 206-7	220 V	9,0 KW
324 206-6	240 V	2,2 KW
324 206-5	240 V	7,5 KW
324 206-4	240 V	4,5 KW
324 206-3	220 V	2,2 KW
324 206-2	220 V	7,5 KW
324 206-1	220 V	4,5 KW

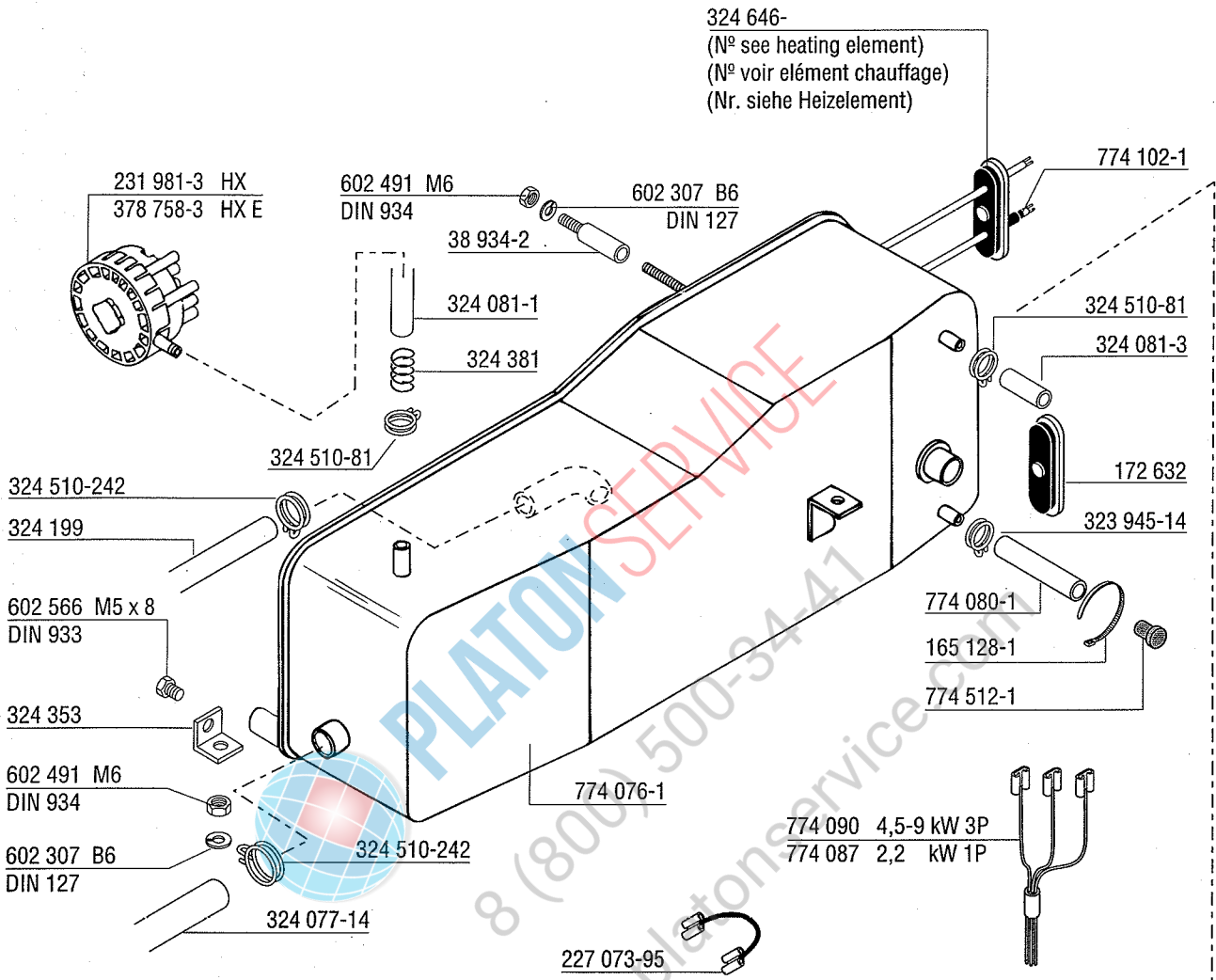

HX 30/30S
HX 40/40S

774 539	
Service kit	(heater) incl. items
Composition du kit	(chaudière) incl. pièces
Umbausatz	(Durchlauferhitzer) inkl. Teile
227 073-95	774 512-1
774 090	323 945-14
774 513-1	774 080-1
774 102-1	774 076-1
165 128-1	

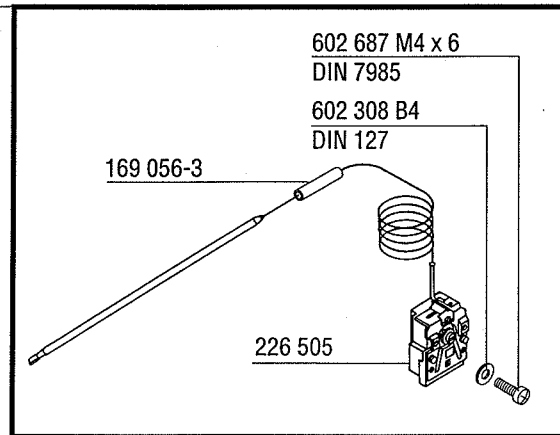

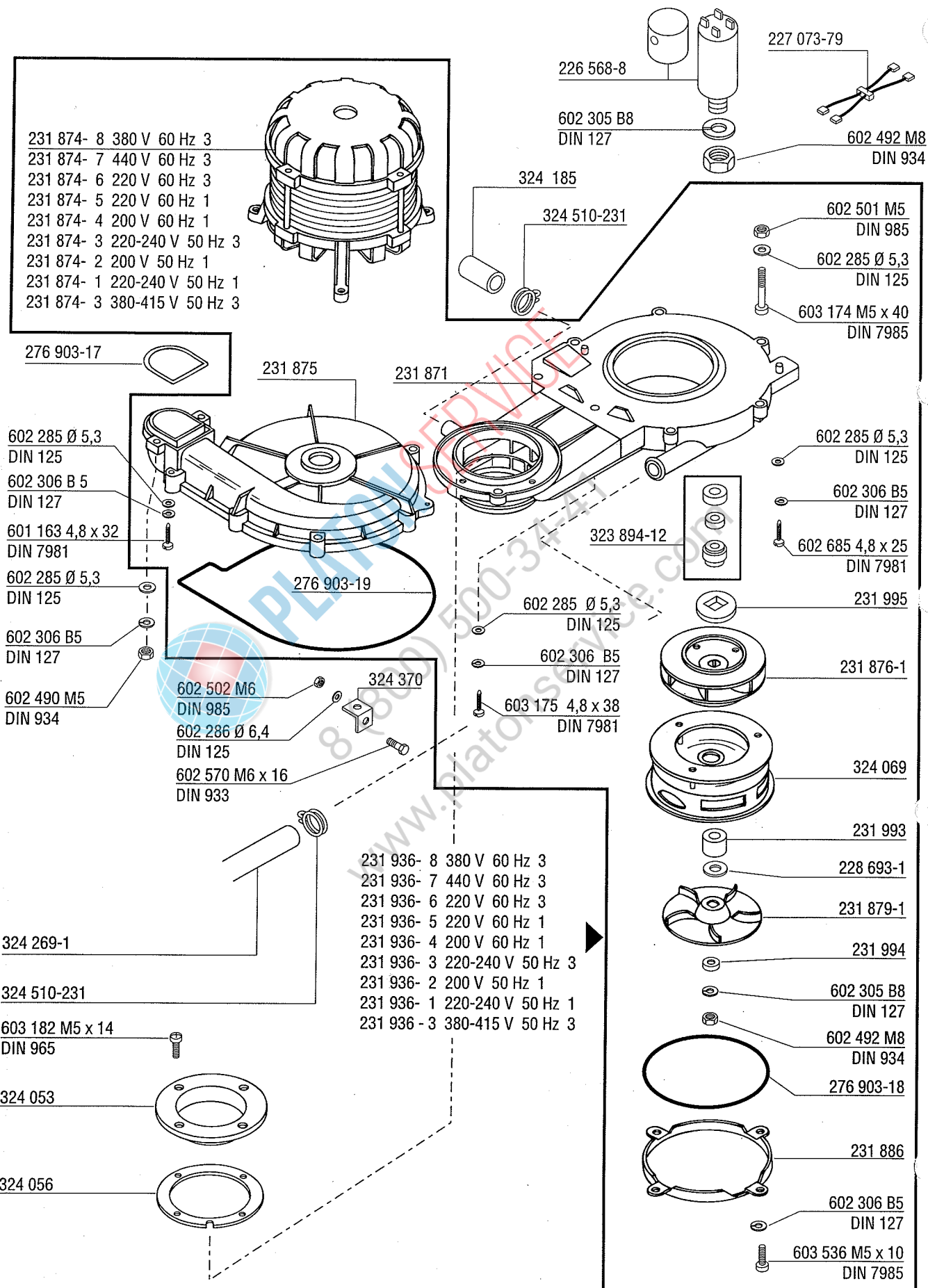

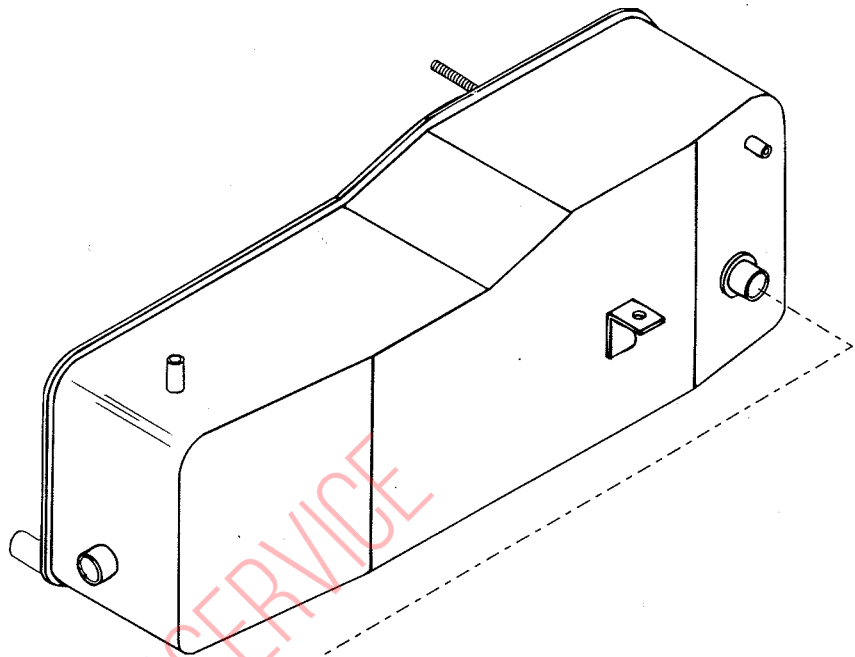

324 093-7	440 V 60 Hz 3
324 093-6	220 V 60 Hz 3
324 093-5	200 V 60 Hz 1
324 093-4	380-415 V 50 Hz 3 N
324 093-3	220 V 60 Hz 1
324 093-2	200 V 50 Hz 1
324 093-1	220-240 V 50 Hz 1

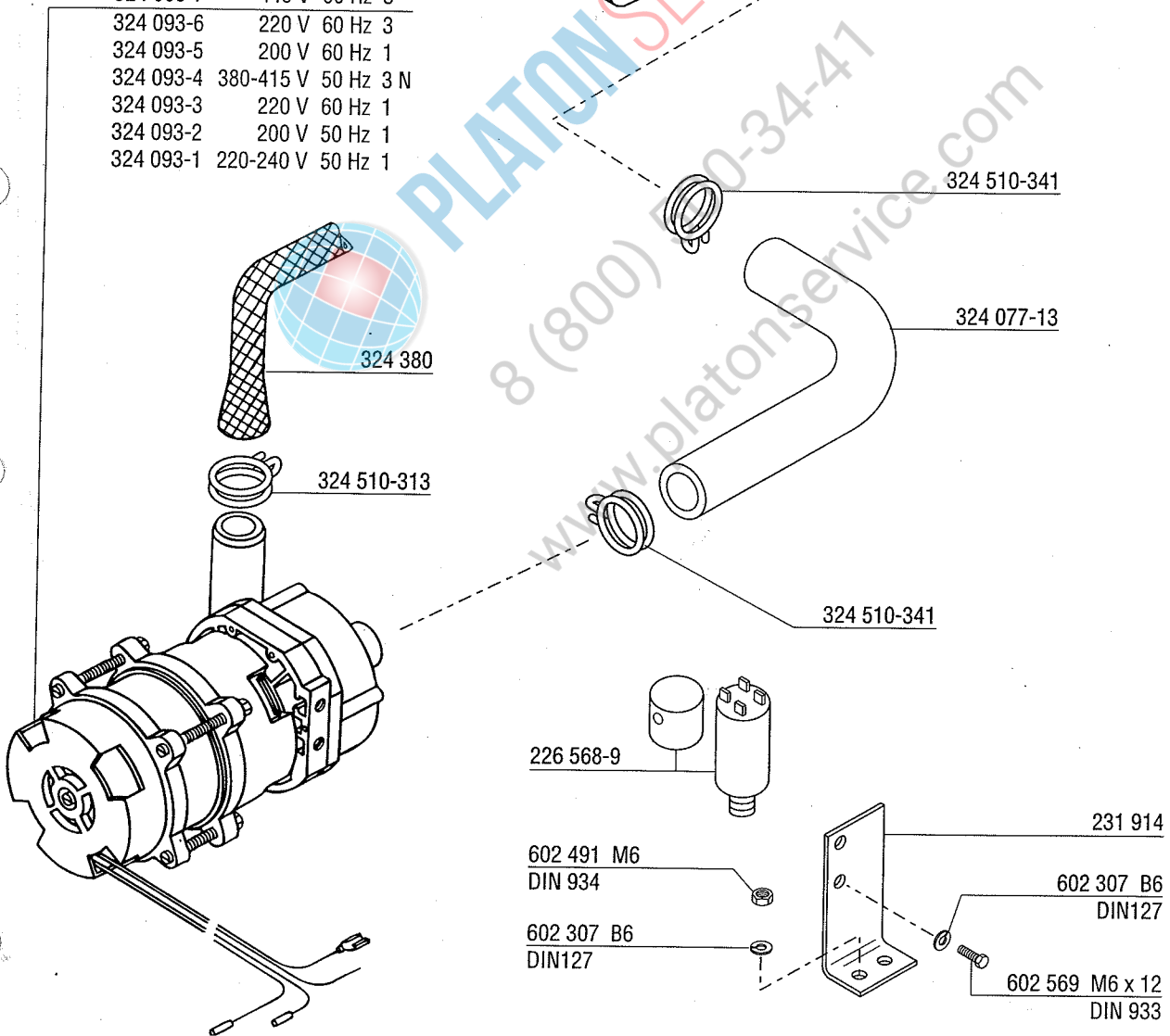

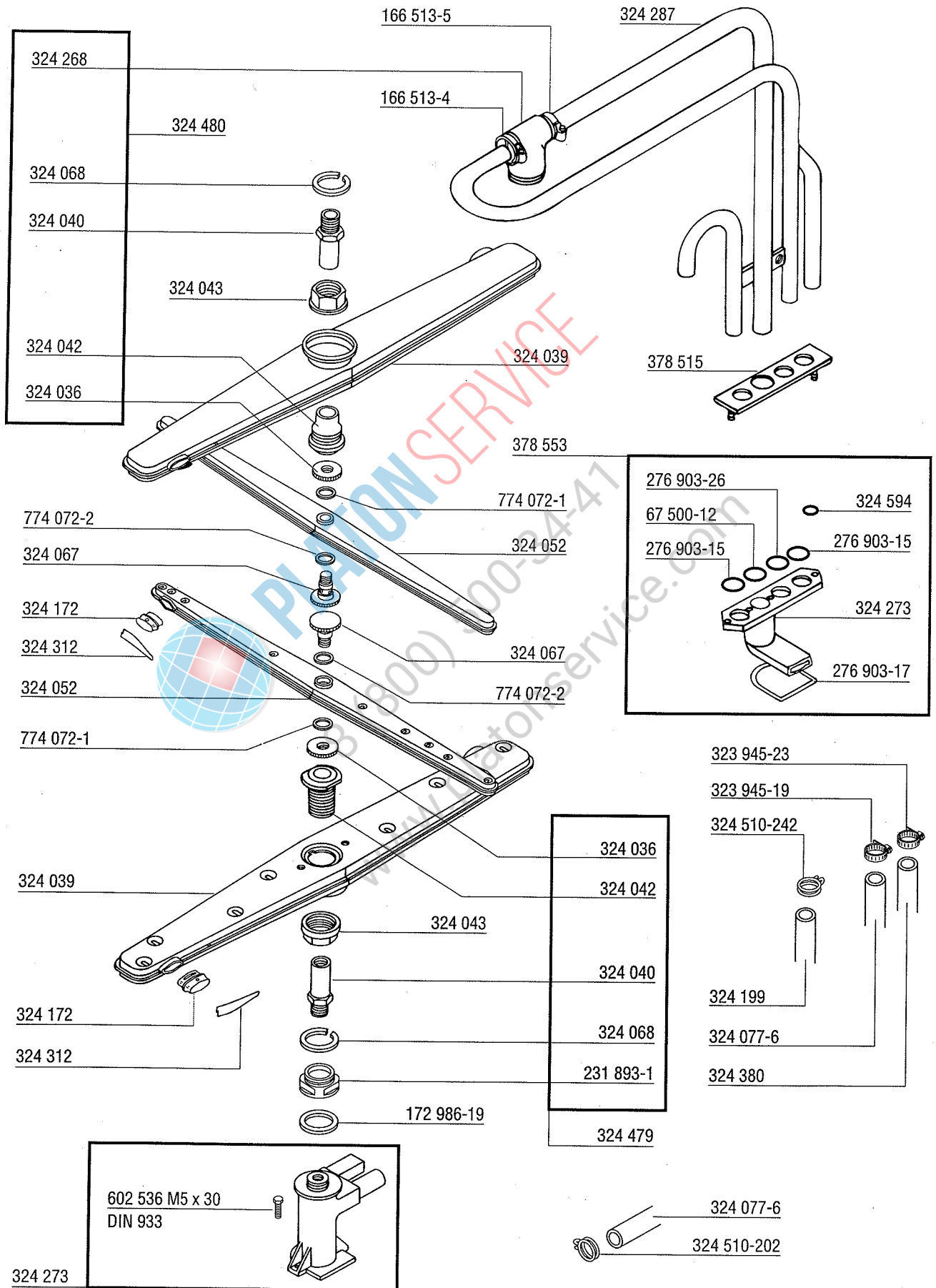

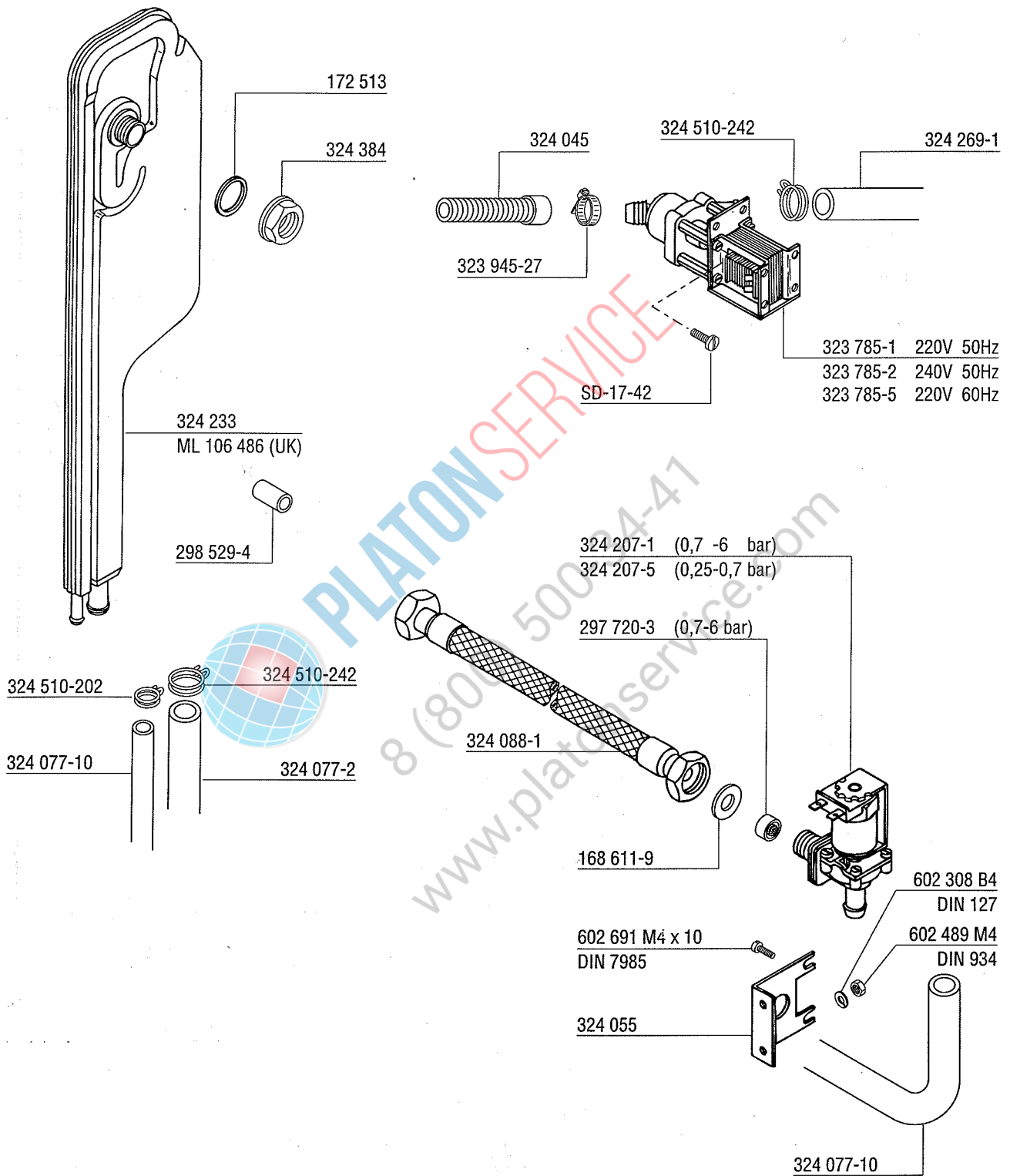

detergent
détergent
Reiniger
wasmiddel

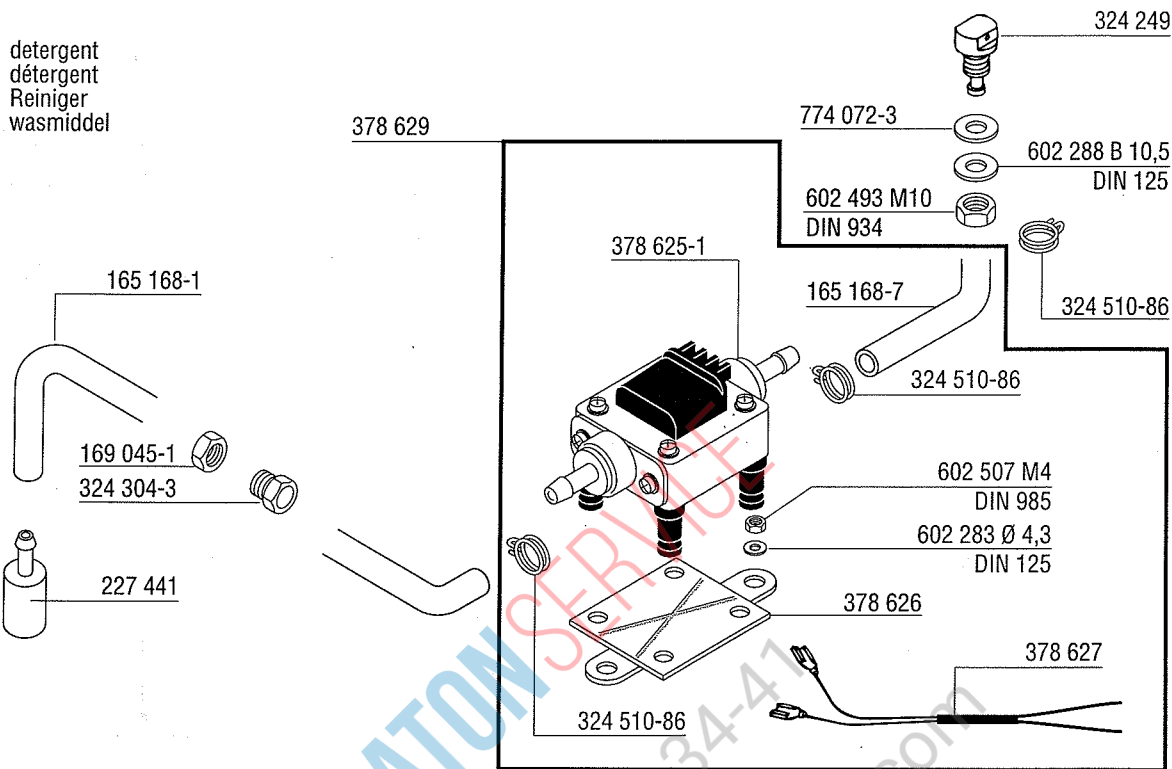

PLATON SERVICE
8 (800) 500-34-41
www.platonservice.com

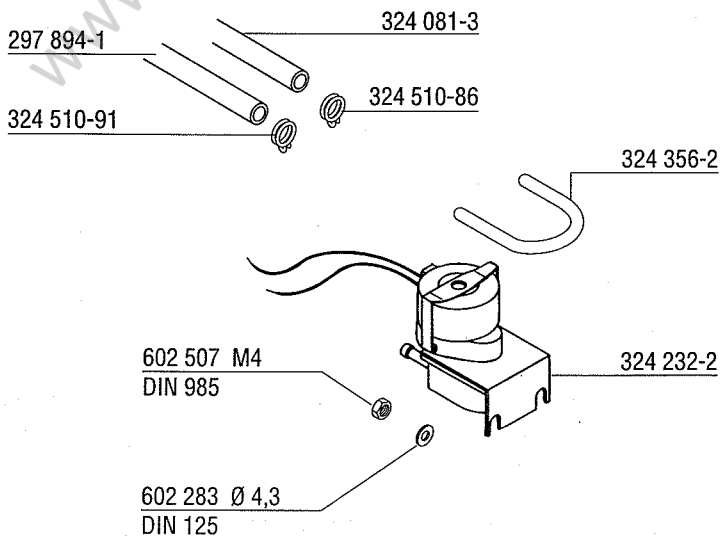

rinse agent
produit de rincage
Klarspüler
naspölmiddel

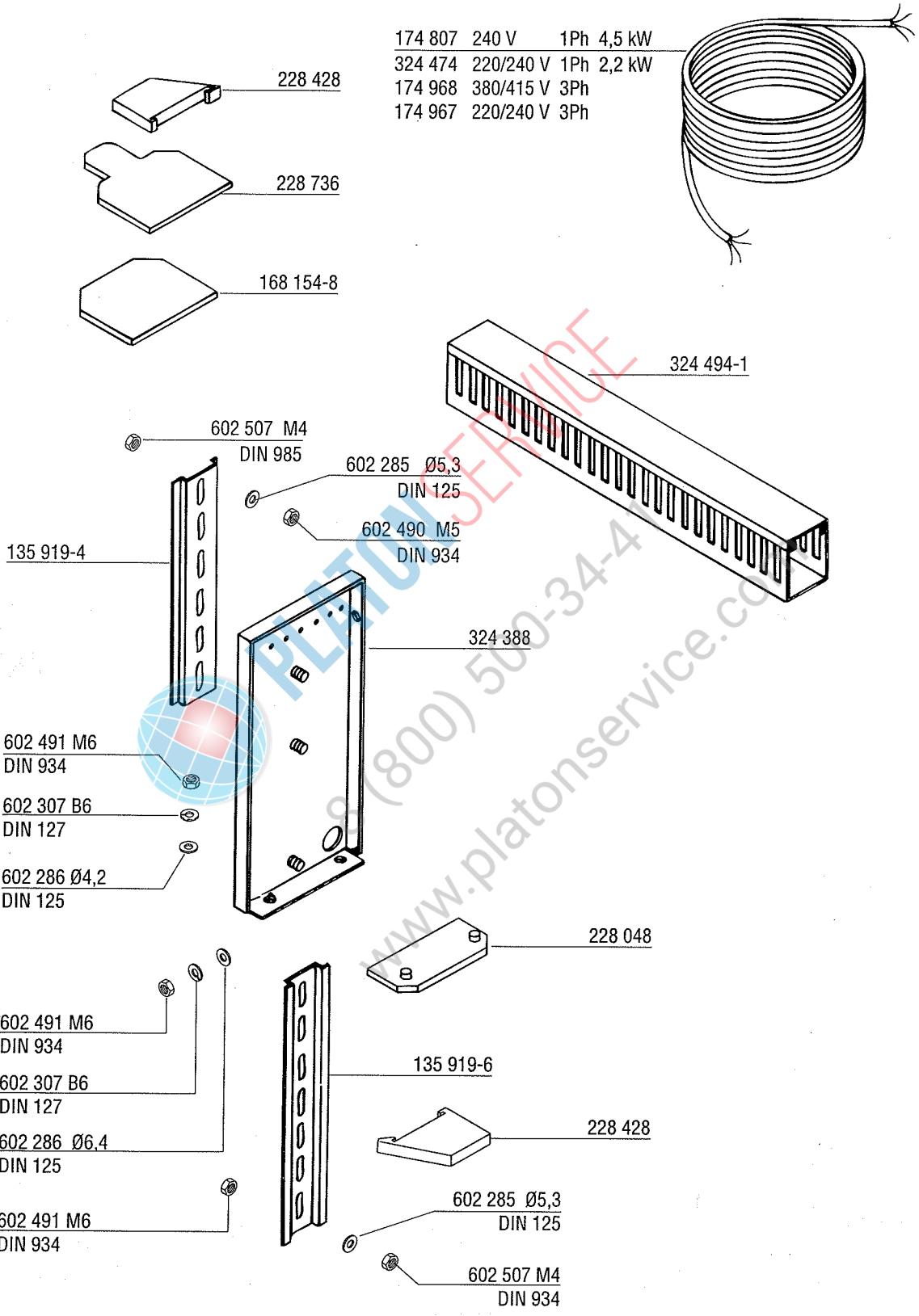

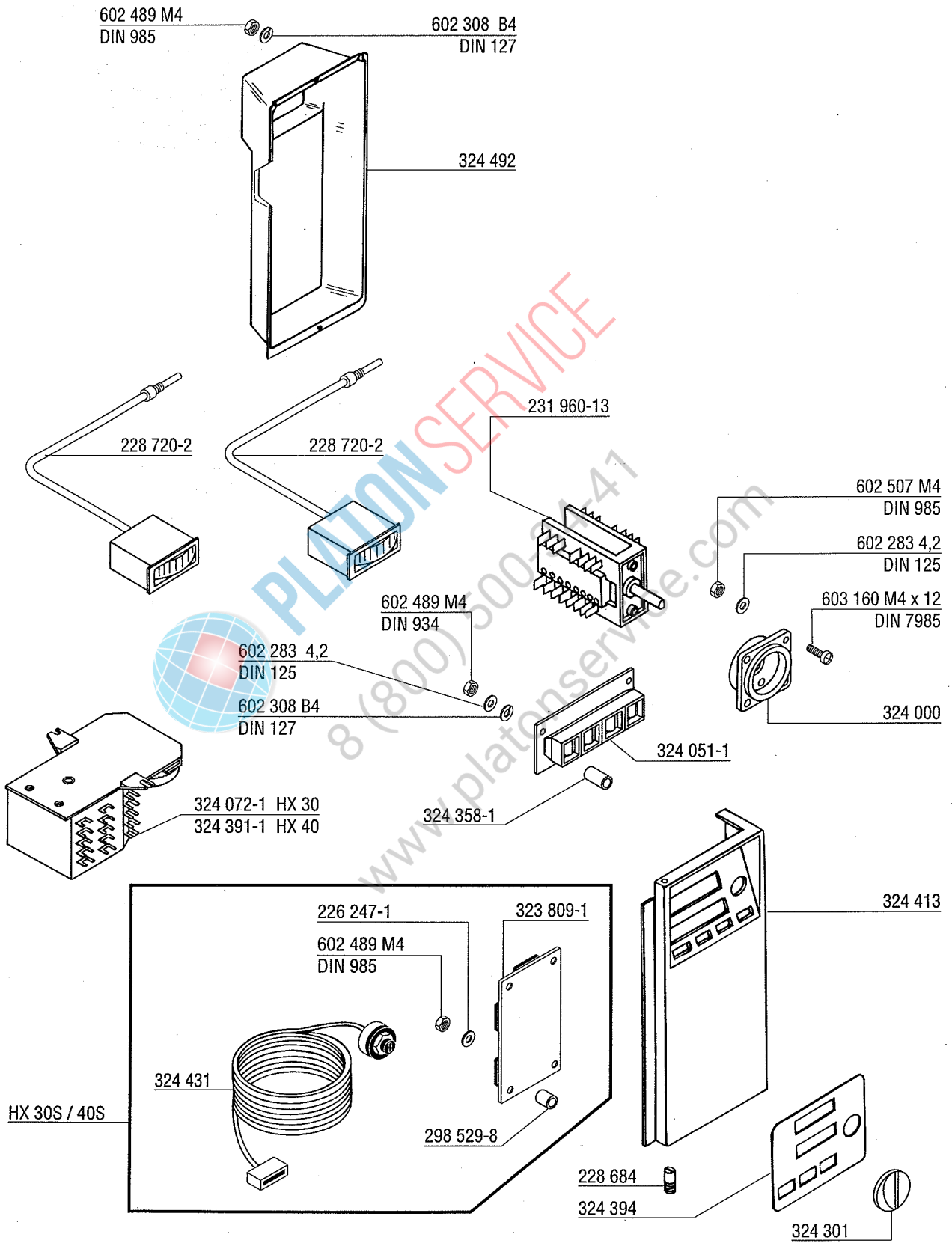

Part Pièce Elektroteil Elektrodeel	Symbol Symbole Symbol Symbol	Contacts Contacts Kontakte Contacte	El. connection El. connexion El. Anschluß El. aansluiting	No. No. Nr. No.
	K1 K3 K2 K5 		220V - 240V 50Hz	301 749-11
			220V - 240V 60Hz	301 749-13
	K4 K8 		220V - 240V 50Hz	379 079-9
			220V - 240V 60Hz	379 079-6
	X16 		6 mm ²	228 429-3
	X16 		6 mm ²	296 983-3
	X16 	F1 - F3 	4 mm ²	167 938
			4 mm ²	228 047
	X17 		2,5 mm ²	228 735-1
	K6 K7 		3 - 30 sec.	228 180-1
			0,5 - 5 sec.	228 180-3
	F1 - F3 		250V 6,3A	226 660-3
	T1 		220V - 240V 50 / 60 Hz	167 231-1

Electrical parts not shown see wiring diagram.

Pour les pièces électriques non apparentes voir schéma de câblage.

Nicht gezeigte Elektroteile siehe Schaltplan.

Raadpleeg het elektrisch schema voor de niet afgebeelde elektrische componenten.

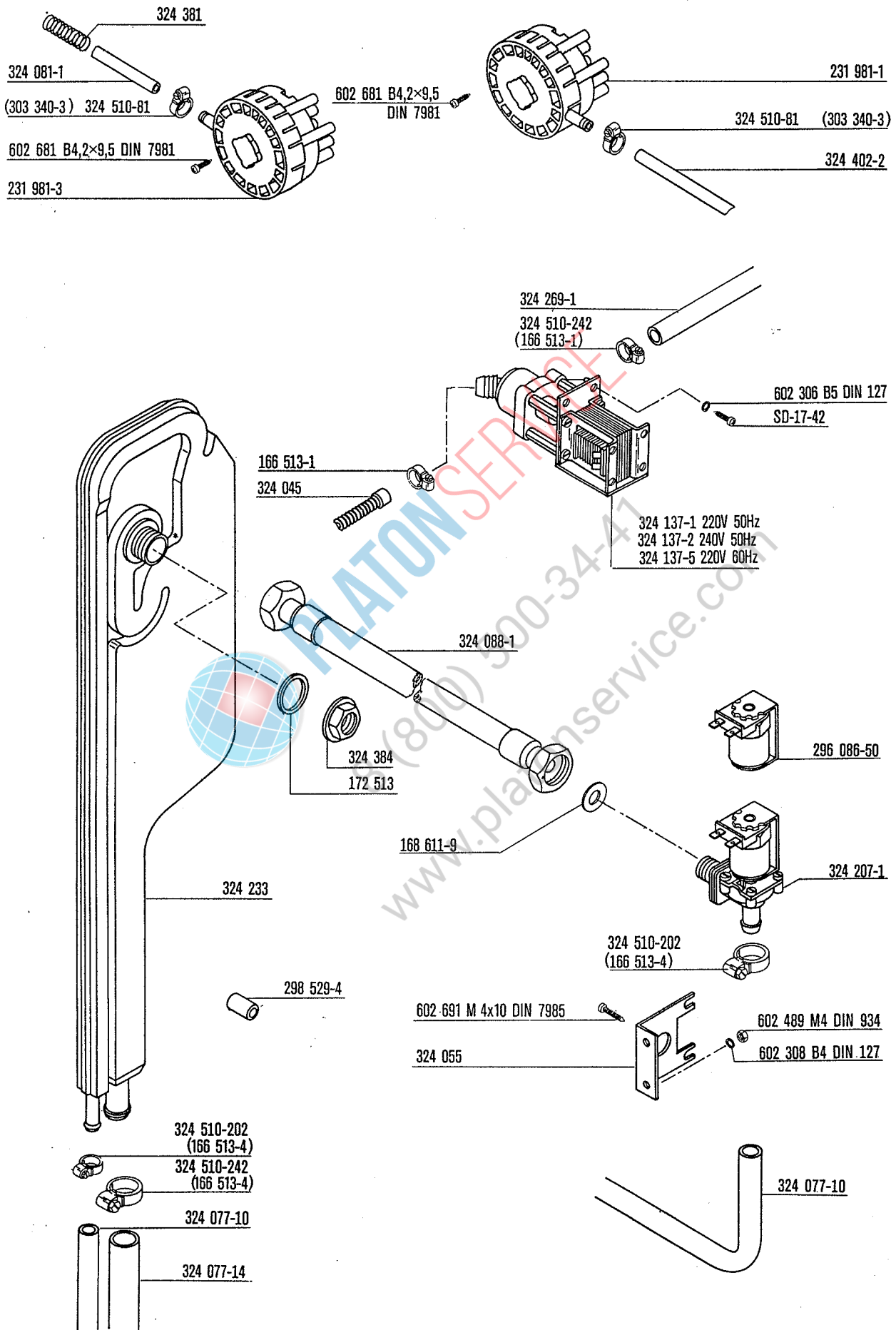

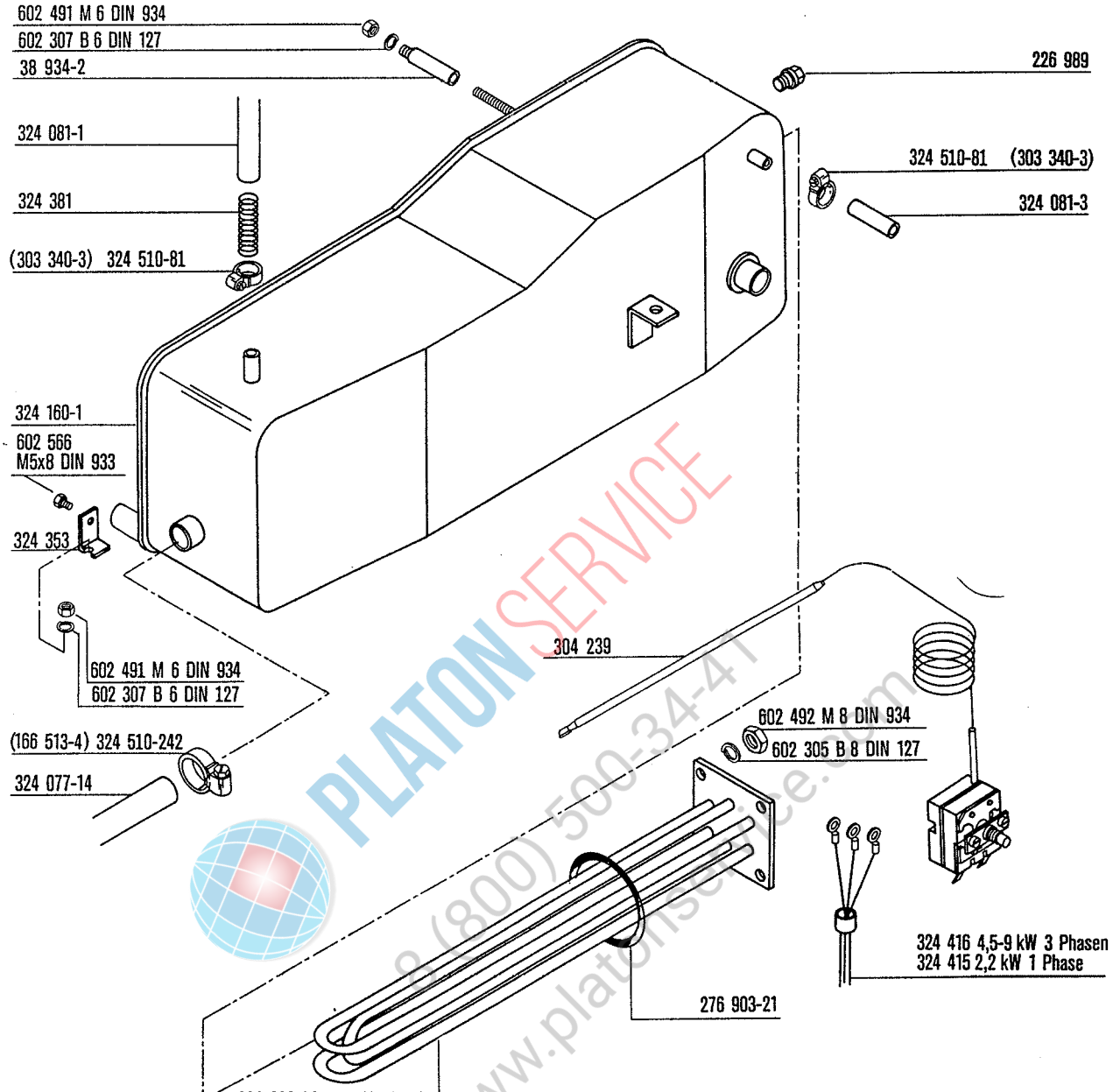

324 206-14	254V	9,0kW
324 206-13	254V	7,5kW
324 206-12	254V	4,5kW
324 206-9	200V	4,5kW
324 206-8	240V	9,0kW
324 206-7	220V	9,0kW
324 206-6	240V	2,2kW
324 206-5	240V	7,5kW
324 206-4	240V	4,5kW
324 206-3	220V	2,2kW
324 206-2	220V	7,5kW
324 206-1	220V	4,5kW

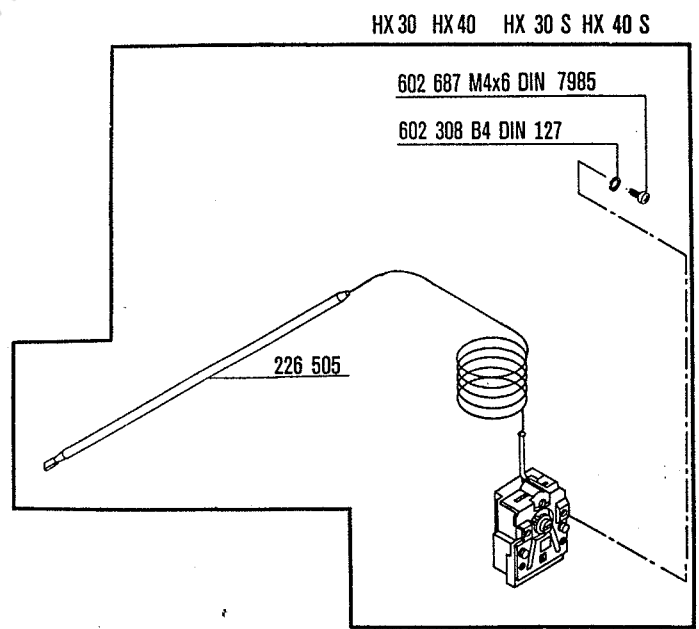

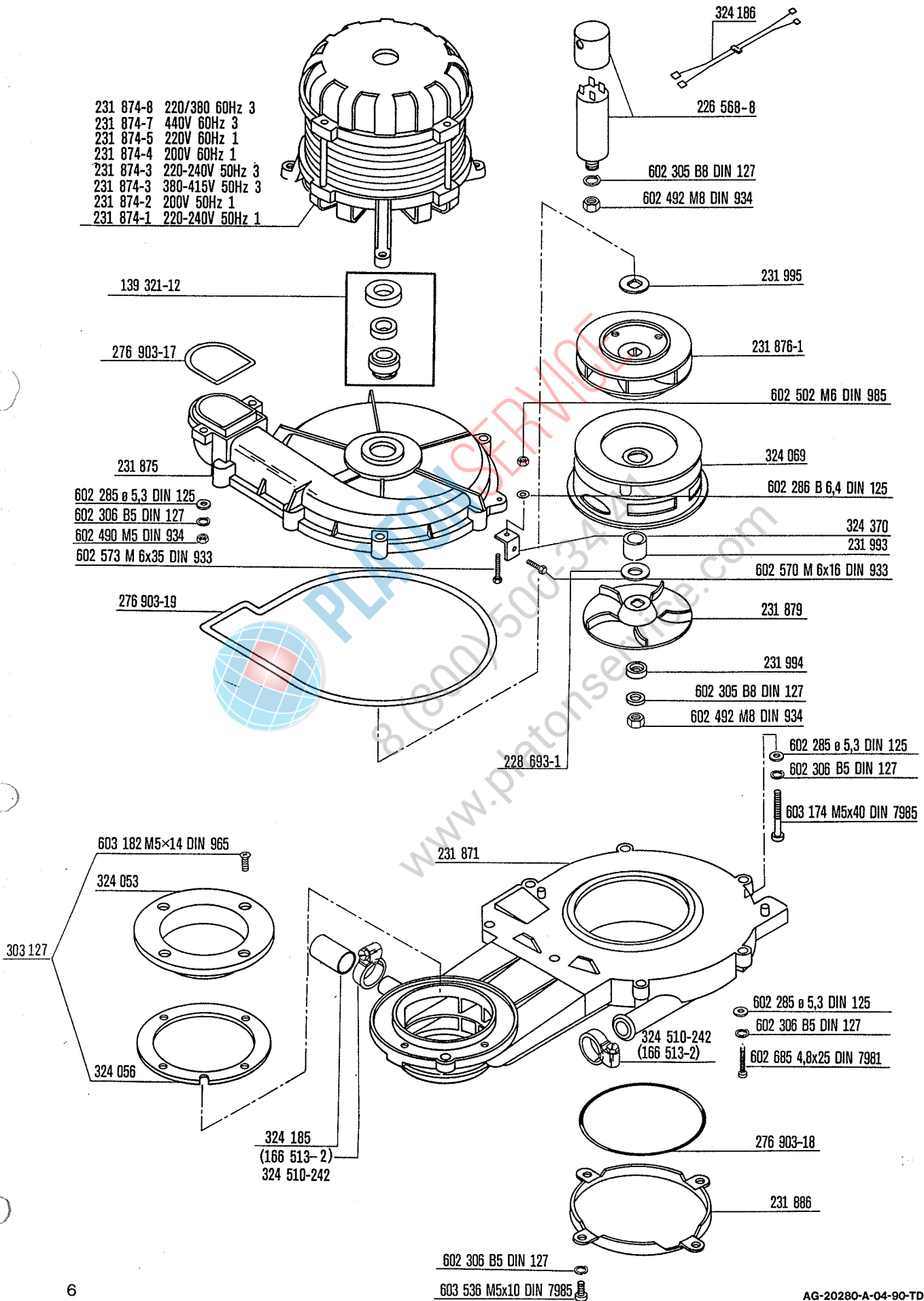

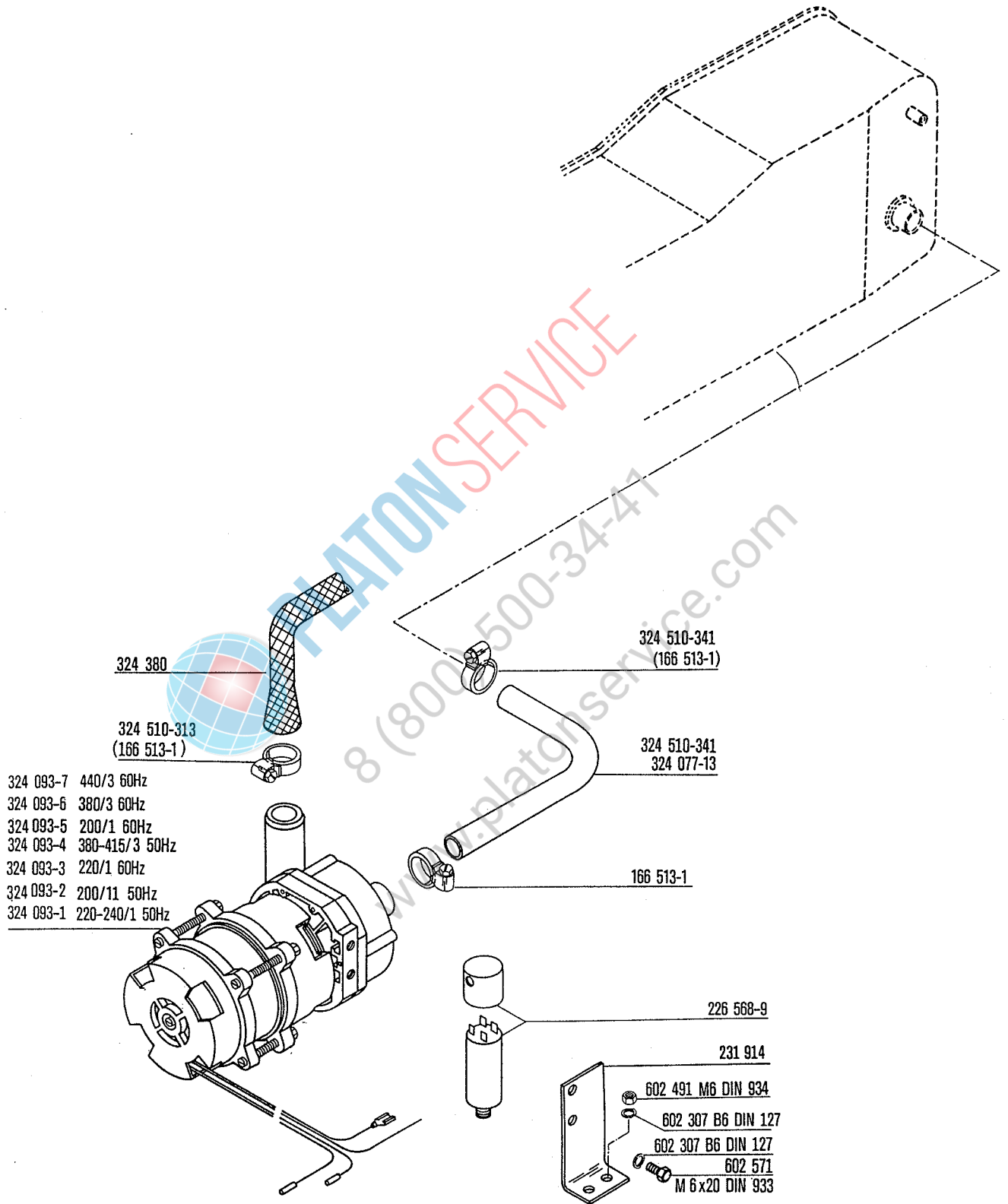

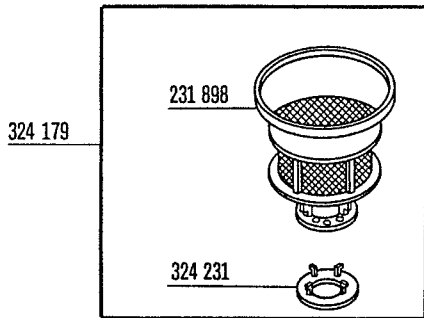
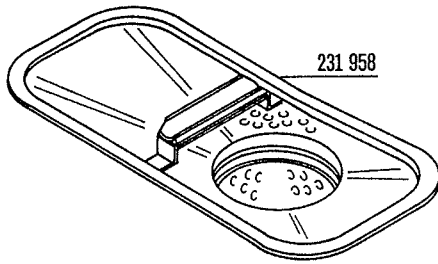

- 231 982-6 200V 500W
- 231 982-5 440V 500W
- 231 982-4 415V 500W
- 231 982-3 380V 500W
- 231 982-2 240V 500W
- 231 982-1 220V 500W

602 294 B3 DIN 127

602 605 M3x5 DIN 84

324 157

602 489 M4 DIN 934

602 308 B4 DIN 127

324 156

606 646 M3x10 DIN 84

324 157

324 157

602 294 B3 DIN127

602 488 M3 DIN 934

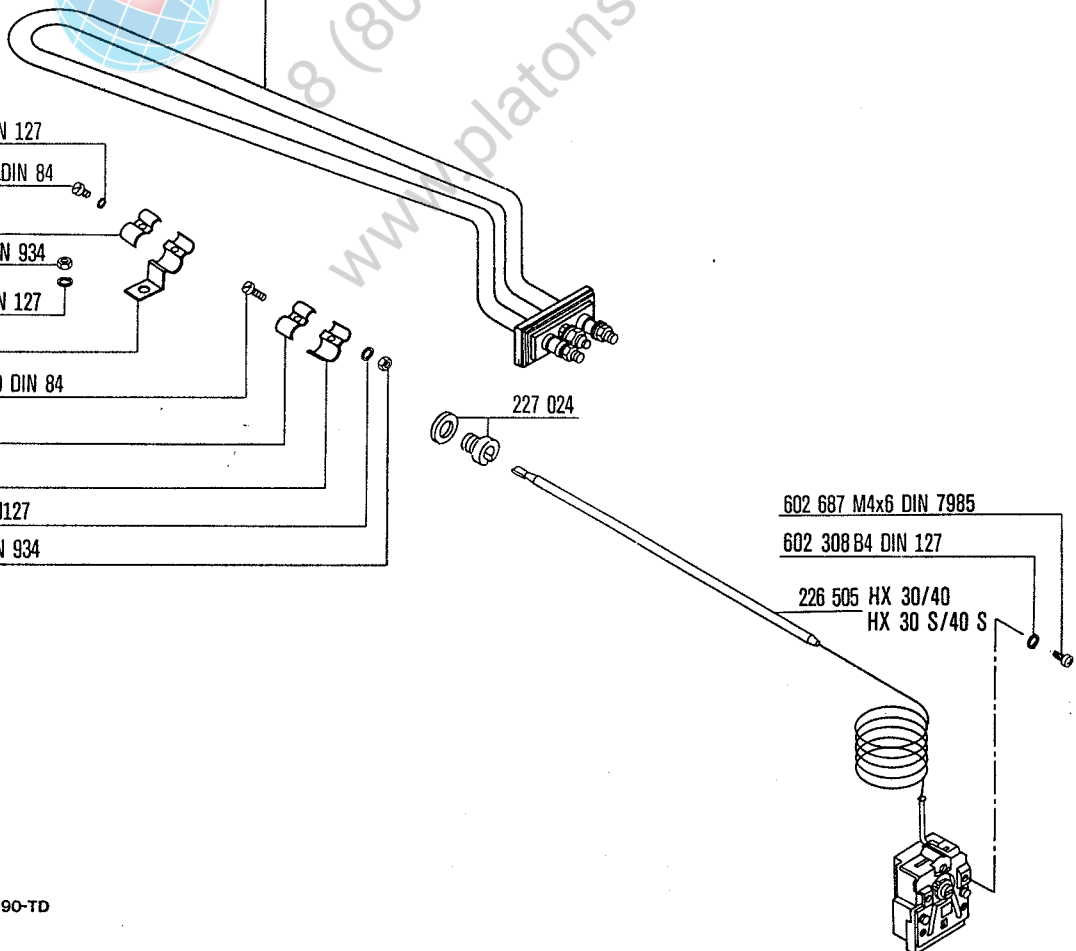

602 687 M4x6 DIN 7985

602 308 B4 DIN 127

226 505 HX 30/40

HX 30 S/40 S

227 024

228 428

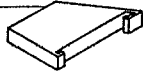

228 736



228 735-1

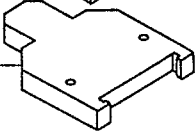

296 983-3

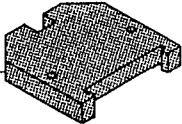

168 154-8

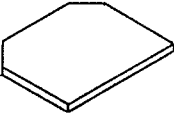

228 429-3

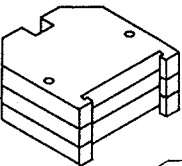

602 507 M4 DIN 985



602 285 B 5,3 DIN 125

602 490 M5 DIN 934

135 919-4

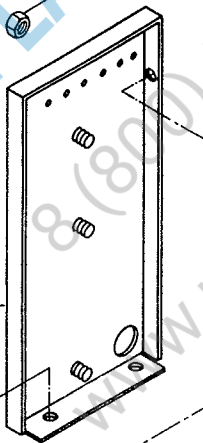
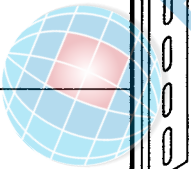

324 388

602 491 M 6 DIN 934

602 307 B 6 DIN 127

602 286 B6,4 DIN 125

602 491 M 6 DIN 934

602 307 B 6 DIN 127

602 286 B6,4 DIN 125

602 490 M5 DIN 934

135 919-4

602 285 B 5,3 DIN 125

602 507 DIN 985

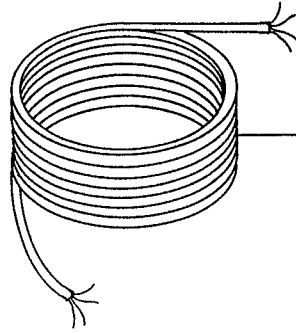

174 807 240 V/1Ph-4,5KW
324 474 220/240/1Ph-2,2KW
174 968 380-415V/3IN
174 967 220/415/3Ph ohne 0

324 494-1

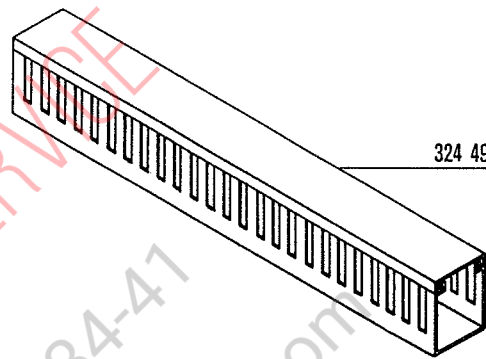

228 428

324 084-3, 220V-60Hz
324 084-2, 240V-50Hz
324 084-1 (220V-50 Hz
240V-60 Hz)

322 067-1 (220V 50/60 Hz-240V 60 Hz)
322 067-2 (240V 50Hz)
322 067-3 (220V 50/60 Hz-240V 60 Hz)
322 067-4 (240V 50Hz)

324 083-1 (220V 50/60 Hz-240V 60 Hz)
324 083-2 (240V 50/60 Hz)

228 048

228 047

226 660-3 (250V)
226 660-13 (450V)

167 938

228 428

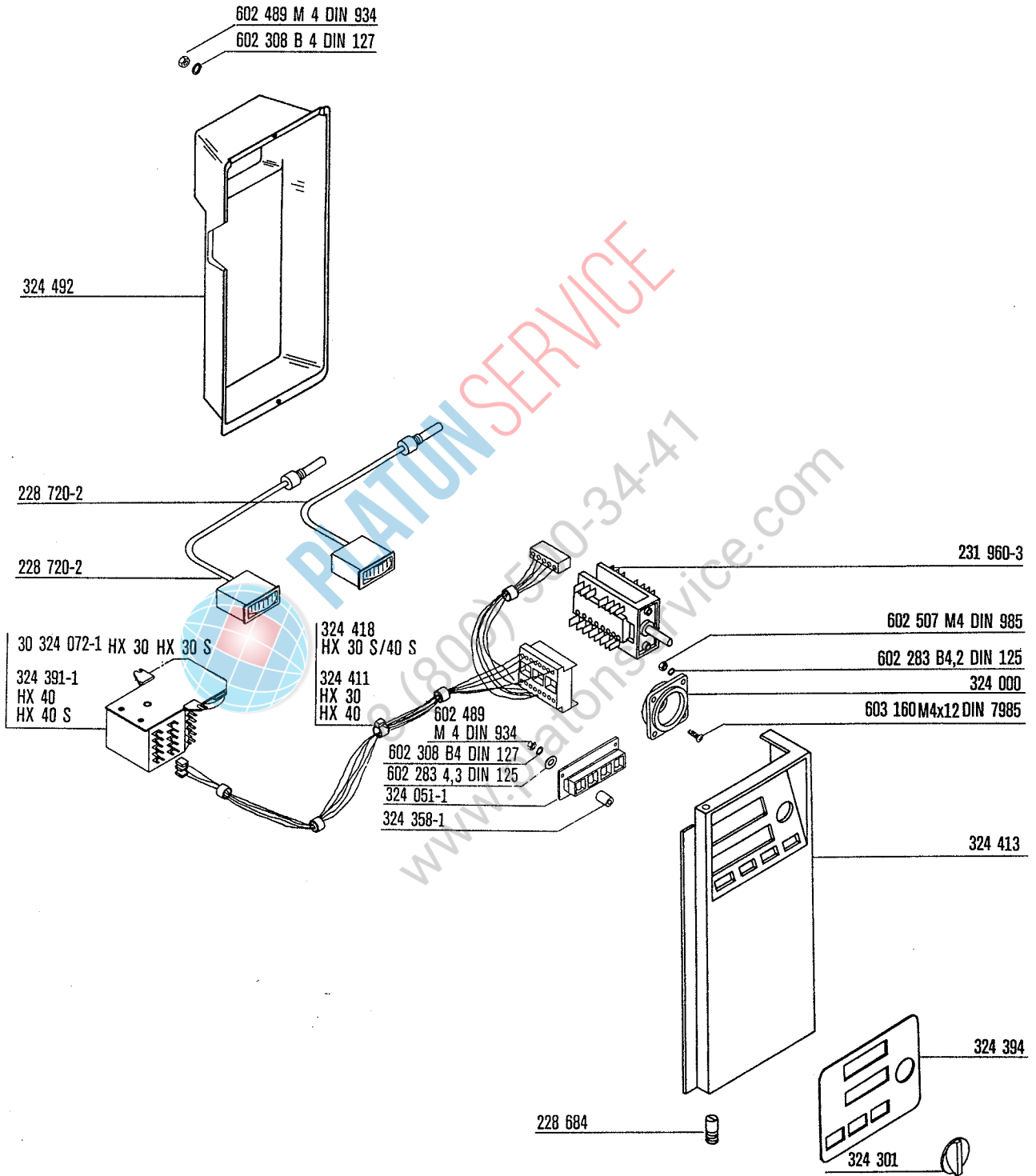

detergent
détergent
Reiniger
wasmiddel

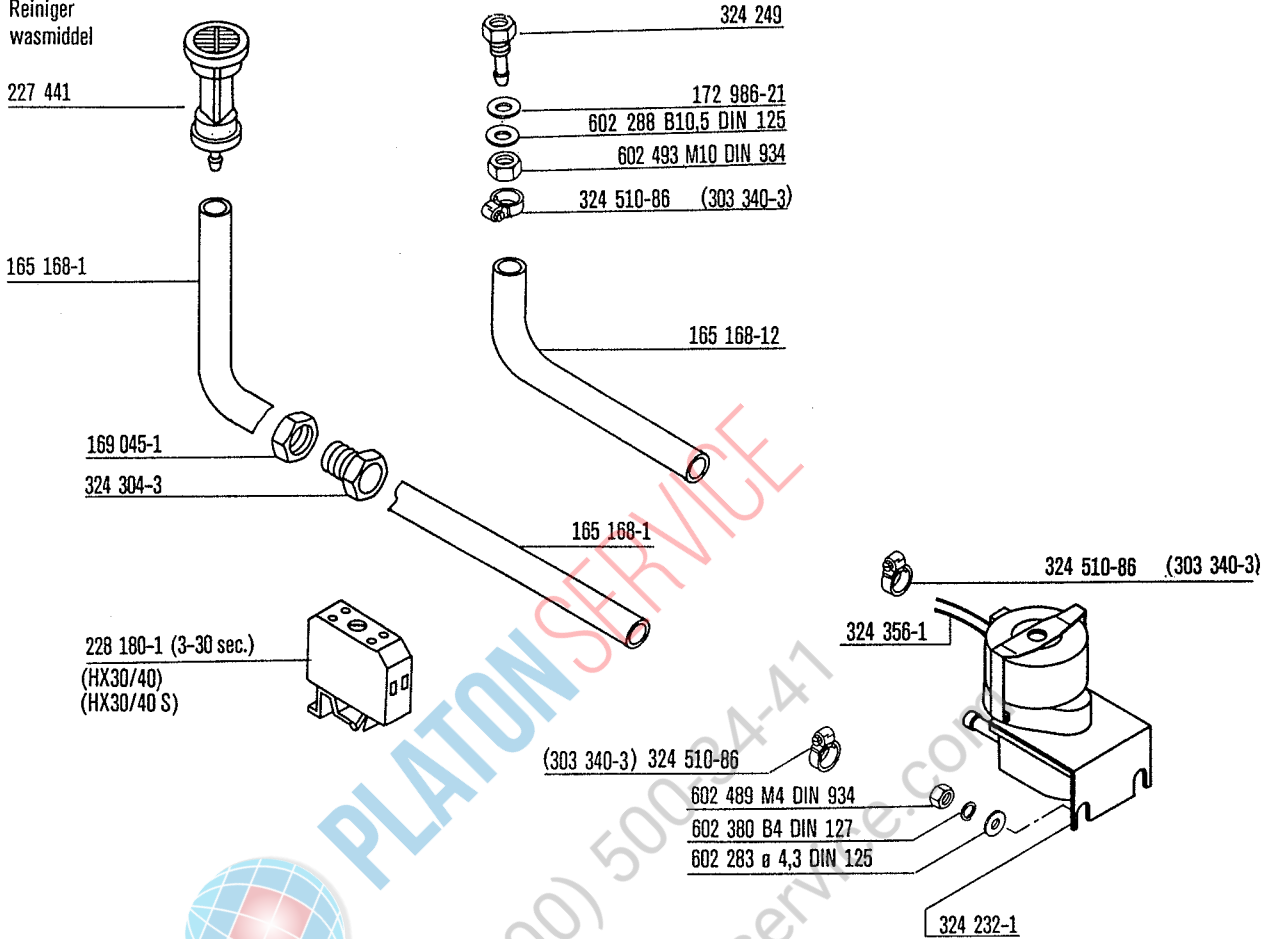

602 489 M4 DIN 934
602 283 4,3 DIN 125

